

...-R-...

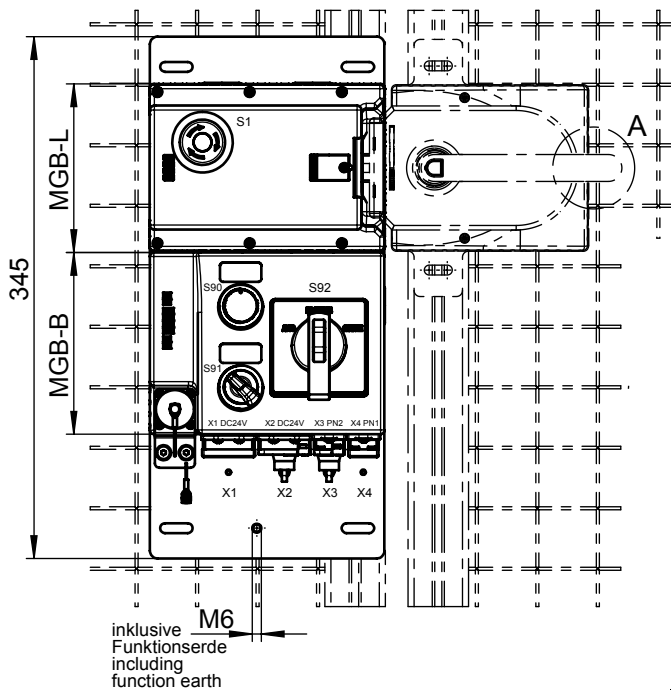

...-L-...

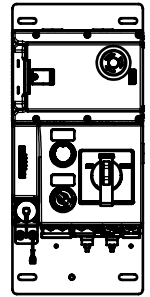

X1 / X2 PushPull Power
X3 / X4 PushPull RJ45
 (IEC 61076- 3-117 variant 14)

X14 RC12 (Buchse/ female)
ES (Zustimmtaster / Enabling Switch)

z.B. ZSB077029
 Anschlussbelegung / PIN assignment

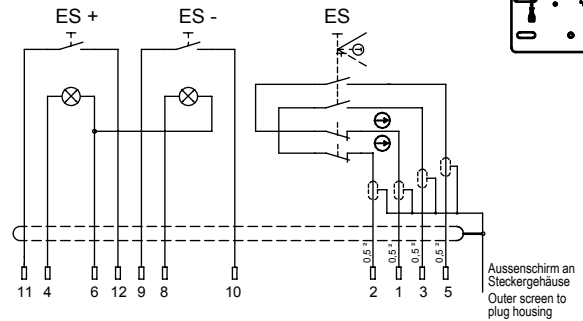
**Detail A**

Sperrverriegelung im
 ausgefahrenen Zustand
 Automatic lockout bar in "open" position.

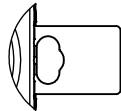

Position		7	6	5
S92.1	AUTO	0	1	1
S92.2	NO-MOTION	1	0	1
S92.3	SERVICE	1	1	0

S92 (BAW)

Betriebsartenwahlschalter
 Operating mode selector switch

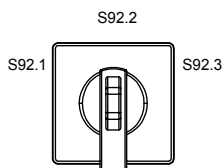

Inklusive:
 2 Stück Einlegeschilder
 silberfarben, selbstklebend.
 (12,5x27mm)

Including:
 2 pcs. insertion plates, silver,
 self-adhesive. (12,5x27mm)

Betriebsanleitung beachten

(Datenstruktur Typ B)
 (bei Abweichungen zwischen
 Datenblatt u. Betriebsanleitung
 gelten die Daten des Datenblattes)

**Please observe the
operating instructions**

(Data structure type B)
 (in case of disagreement between
 data sheet and operating instructions,
 the information of the data sheet
 are to be considered)

	MGB-H	MGB-L...	MGB-E...	Türanschlag Door hinge	S1	S90 Taster beleuchtet Button illuminated	S91 Wahlschalter beleuchtet Selector switch illuminated
MGB-L1B-PNA-R-156194		X		R	NOT-HALT Taster beleuchtet	WEISS WHITE	RASTEND LATCHING 1x90°, Form V
MGB-L1HEB-PNA-R-156195	X	X	X				
MGB-L1B-PNA-L-156196		X		L	Emergency stop illuminated		
MGB-L1HEB-PNA-L-156197	X	X	X				

PROFINET

Eingangsbereich / Input range:		Bit	7	6	5	4	3	2	1	0
MGB-B	Slot 1 Byte 0	-	-	-	-	-	-	-	S91	S90
Emergency stop	Slot 2 Byte 0	-	-	-	-	-	-	-	-	S1
MGB-L	Slot 3 Byte 0	ÜK	SK	-	-	-	Z	R	T	
Op. Mode Selector	Slot 4 Byte 0	-	-	-	-	-	S92.3	S92.2	S92.1	
Enabling switch	Slot 5 Byte 0	-	ES-	ES+	-	-	-	-	-	ES
Diagnostics	Slot 6 Byte 0	-	-	E	E	E	E	E	E	E
Ausgangsbereich / Output range:		Bit	7	6	5	4	3	2	1	0
MGB-B	Slot 1 Byte 0	-	-	-	-	-	-	-	H91	H90
Emergency stop	Slot 2 Byte 0	-	-	-	-	-	-	-	-	H1
MGB-L	Slot 3 Byte 0	-	-	-	-	-	-	-	-	S
Op. Mode Selector	Slot 4 Byte 0	-	-	-	-	-	-	-	-	-
Enabling switch	Slot 5 Byte 0	-	-	-	-	-	-	-	ES-	ES+
Diagnostics	Slot 6 Byte 0	-	-	-	-	-	-	-	Reset	Q

PROFIsafe

Eingangsbereich / Input range:		Bit	7	6	5	4	3	2	1	0
SAFETY	Byte 0	S92.3	S92.2	S92.1	Z	R	T	ES	S1	
	Byte 1	-	-	-	-	-	-	-	ÜK	SK
	Byte 2-5	PROFIsafe intern genutzt (Steuerbyte, CRC usw.) Used within Profisafe (control byte, CRC etc.)								
Ausgangsbereich / Output range:		Bit	7	6	5	4	3	2	1	0
SAFETY	Byte 0	-	-	-	-	-	-	-	-	S
	Byte 1	-	-	-	-	-	-	-	-	-
	Byte 2-5	PROFIsafe intern genutzt (Statusbyte, CRC usw.) Used within Profisafe (status byte, CRC etc.)								

ÜK = T and R and Z
 SK = T and R
 L = Lebensdauer / Life

Z = Zuhaltung / guard locking
 R = Riegelstellung / bolt position
 T = Türstellung / door position

E = Gerätediagnose / Device diagnosis
 Q = Quittierung / Acknowledgement
 S = Zuhaltmagnet / Guard locking solenoid