

Maße in mm / Dimensions in mm



© EUCHNER GmbH + Co. KG

Technische Änderungen vorbehalten, alle Angaben ohne Gewähr / Subject to technical modifications; no responsibility is accepted for the accuracy of this information.

Inklusive:
Including:

Einlegeschilder, silberfarben:
Insertion plates, silver:
2x ohne Aufschrift / without inscription

Blenden-Set für Taster:
Lens-Set for button:

2x weiss / white
1x blau / blue
1x gelb / yellow
1x grün / green
1x rot / red

Schrauben:
Screw:

6x 3x10
1x 2,5x10

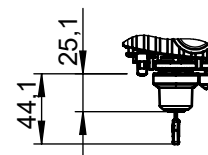

	Produktversion Product version	Verbindungskabel inklusive Connection cable included	Türanschlag Door hinge	S1	S2	S3	S4
MGB-A-COVER-R-R6-175510	ab / from V 4.0.0	-	R	NOT-HALT Taster Emergency stop	Taster beleuchtet Button illuminated	Schlüsselschalter Key-operated, rotary switch RASTEND LATCHING 2x90°, 0+1+ 2 = Schlüssel abziehbar 0+1+2 = Key removable	Taster beleuchtet Button illuminated
MGB-A-COVER-L-R6-175511	ab / from V 4.0.0	-	L				

...-R-...

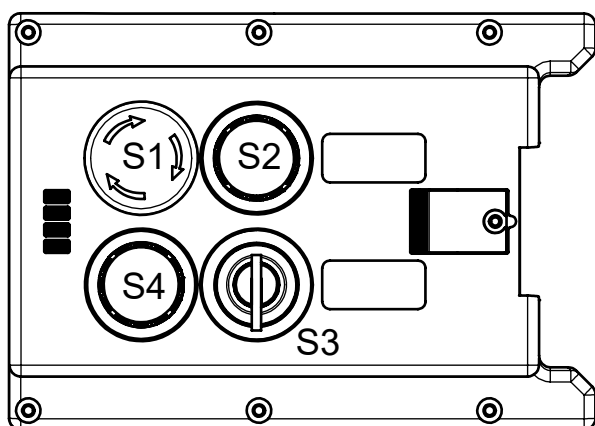

...-L-...

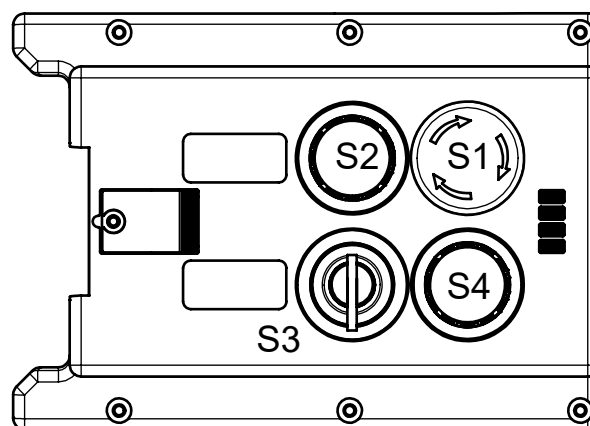

Belegung
Deckeltaster:

PIN assignment
top cover button:

